

KROKİLER VE LİSTELER

KAYSERİ İLİ, KOCASINAN İLÇESİ, YUNUSEMRE MAHALLESİ KENTSEL DÖNÜŞÜM VE GELİŞİM PROJE ALANI SINIR KROKİSİ

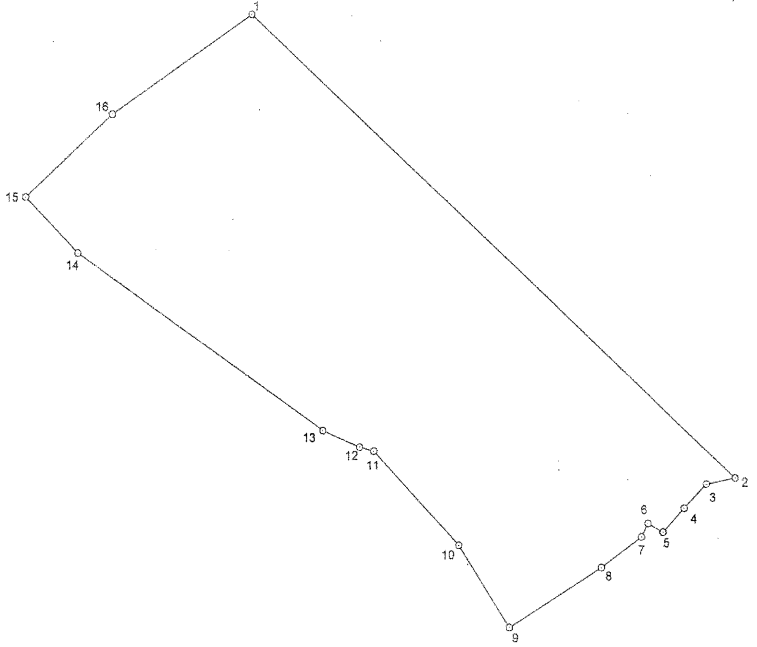

Alan: 12.53 ha
(Projeksiyon UTM-3, Datum: ITRF96, DOM:36)

KAYSERİ İLİ, KOCASINAN İLÇESİ, YUNUSEMRE MAHALLESİ

KENTSEL DÖNÜŞÜM ve GELİŞİM PROJE ALANI

SINIR KÖŞE KOORDİNATLARI

(Projeksiyon UTM-3, Datum: ITRF96, DOM:36)

NoktaNo	Y	X
1	452370.443	4290216.258
2	452800.611	4289839.256
3	452775.096	4289834.234
4	452755.633	4289814.545
5	452736.558	4289794.902
6	452723.046	4289802.072
7	452717.104	4289791.075
8	452681.604	4289766.068
9	452599.431	4289717.190
10	452554.559	4289783.983
11	452478.752	4289860.970
12	452466.126	4289864.173
13	452433.403	4289877.614
14	452216.213	4290021.025
15	452169.473	4290066.635
16	452246.952	4290134.243

KAYSERİ İLİ, KOCASINAN İLÇESİ, ALSANCAK MAHALLESİ
KENTSEL DÖNÜŞÜM VE GELİŞİM PROJE ALANI
SINIR KROKİSİ

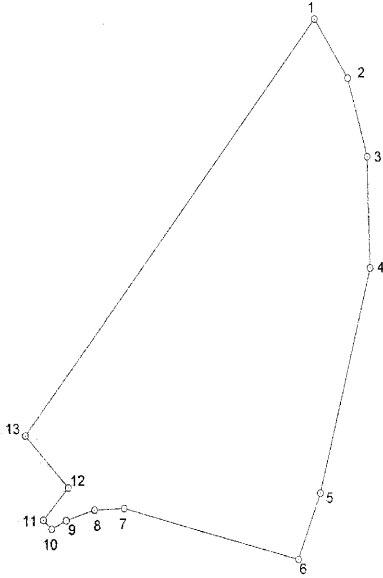

Alan: 6.90 ha
(Projeksiyon UTM-3, Datum: ITRF96, DOM:36)

KAYSERİ İLİ, KOCASINAN İLÇESİ, ALSANCAK MAHALLESİ
KENTSEL DÖNÜŞÜM ve GELİŞİM PROJE ALANI
SINIR KÖŞE KOORDİNATLARI

(Projeksiyon UTM-3, Datum: ITRF96, DOM:36)

NoktaNo	Y	X
1	458089.475	4291605.607
2	458118.018	4291559.391
3	458134.679	4291498.267
4	458136.809	4291411.885
5	458092.118	4291237.368
6	458072.779	4291186.284
7	457920.901	4291226.569
8	457894.909	4291225.308
9	457870.452	4291217.206
10	457858.009	4291210.676
11	457850.724	4291217.522
12	457872.548	4291242.455
13	457835.601	4291283.014

KAYSERİ İLİ, KOCASINAN İLÇESİ, SEYRANI MAHALLESİ
KENTSEL DÖNÜŞÜM VE GELİŞİM PROJE ALANI
SINIR KROKİSİ

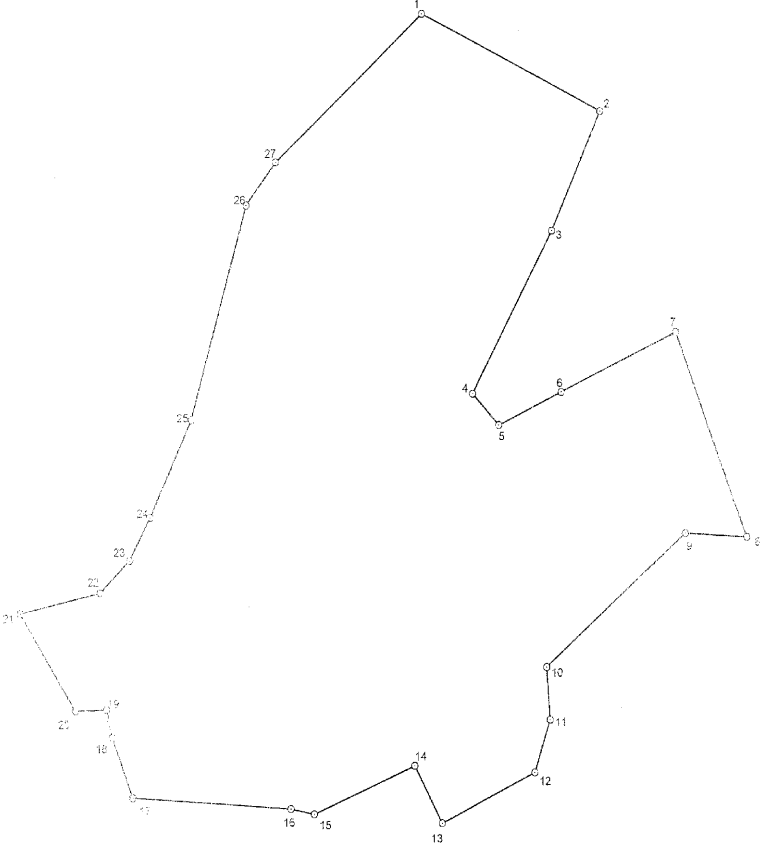

Alan: 44.18 ha

(Projeksiyon UTM-3, Datum: ITRF96, DOM:36)

KAYSERİ İLİ, KOCASINAN İLÇESİ, SEYRANI MAHALLESİ
KENTSEL DÖNÜŞÜM ve GELİŞİM PROJE ALANI

SINIR KÖŞE KOORDİNATLARI

(Projeksiyon UTM-3, Datum: ITRF96, DOM:36)

NoktaNo	Y	X
1	454802.808	4291572.232
2	455031.036	4291462.158
3	454968.223	4291327.502
4	454866.028	4291145.046
5	454899.694	4291109.681
6	454979.701	4291146.570
7	455127.514	4291213.386
8	455217.230	4290983.096
9	455139.164	4290987.534
10	454959.920	4290837.277
11	454964.270	4290778.173
12	454944.261	4290718.680
13	454825.338	4290661.942
14	454790.298	4290727.001
15	454661.567	4290672.502
16	454631.888	4290678.403
17	454429.961	4290690.429
18	454404.070	4290758.474
19	454397.079	4290790.018
20	454356.770	4290788.437
21	454286.422	4290897.791
22	454389.017	4290920.818
23	454426.949	4290957.202
24	454453.906	4291005.815
25	454506.635	4291115.726
26	454577.550	4291357.029
27	454615.434	4291405.645